

RESIDENTIAL

"ALBA - SALINA 2 - Phase 3"

Rojales

Updated: 20-04-26

Phase	Property n°	m2 plot	Bedrooms	m2 built	Baths	Toilet	Price	Situation	Completion date
3	16	205,35	3	130,20 + 61,20 basement = 191,40 m2	3	1	---	SOLD	---
	17	124,95	3	108,20 + 59,25 basement = 167,45m2	2	1	369.900 €	Available	July'26
	18	124,80	3	108,20 + 59,25 basement = 167,45m2	2	1	Show House	Available	---
	19	124,65	3	108,20 + 59,25 basement = 167,45m2	2	1	---	SOLD	---
	20	124,48	3	108,20 + 59,25 basement = 167,45m2	2	1	---	Available	---
	21	124,32	3	108,20 + 59,25 basement = 167,45m2	2	1	369.900 €	Available	July'26
	22	127,85	3	108,20 + 59,25 basement = 167,45m2	2	1	---	SOLD	---

EXTRAS INCLUDED

SWIMMING POOL & BASEMENT INCLUDED in the price

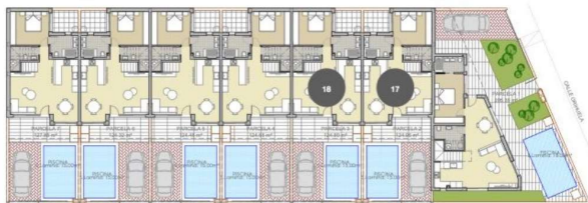

POSIBLES EXTRAS // POSSIBLE EXTRAS

-Solarium with metal staircase.....15.500€

*INCLUDED IN THE PRICE:

- Suelo radiante en baños.
- Underfloor heating on the bathrooms.
- Mampara de ducha en todos los baños.
- Shower screen in all the bathrooms
- Muebles de baño con espejo y luz en todos los baños.
- Bathroom cabinets with mirror & light in all bathrooms.
- Frigo integrado, campana extractora, vitro, horno, lavadora y lavavajillas.
- Inset fridge, extractor fan, vitro, oven, washing machine & dishwasher.
- Persianas de aluminio motorizadas.
- Electric aluminium blinds.
- Cristales "Guardian Sun" en las ventanas.
- "Guardian Sun" glasses on the windows.
- Armarios empotrados en todas las habitaciones acabados con cajoneras.
- Built-in wardrobes, with wooden lined interiors, drawers and hanging bars
- Pre-instalación aire acondicionado por conductos.
- Air conditioning pre-installation in all the house.
- Puerta de entrada de seguridad con seis puntas de anclaje.
- Entrance security door with six anchor points.
- Motor de control remoto para la puerta del coche.

Nota.- Los precios no incluyen IVA
Note.- The prices don't include IVA tax

"Documento en valor contractual / This document has no contractual value"